

## Sequencing blowdown valve

Type SPV

### Description

The sequencing valve is designed to function as a combined water isolating valve and a sequencing valve to provide positive purging of the water connection, float chamber and steam connection of a boiler control. Blowdown of float chamber and connections are affected separately and in a pre-determined sequence by the operation of the single specially designed hand wheel.



### Function

Steam boiler external level control chamber isolation and purge.

### Features

- One valve to provide separate blowdown of:
- Control Chamber
  - Steam Connection
  - Water Connection

### Limiting conditions

Maximum working pressure for the Cast iron material is 10 bar and for the Gunmetal material is 20 bar.



## Size and pipe connections

Dimensions (approx.) in mm

Size	Body material	Flange connections	D	N	O	P	A	B	H	C
1" DN25	Cast iron	BS 4504 PN16 (Inlet and outlet)	115	4	14	85	83	83	219	54
	Gunmetal	BS 4504 PN40 (Inlet and outlet)	115	4	14	85	83	83	219	54

### Inlet and Outlet flange

N = No. of holes

O = Dia. of holes

P = Pitch circle dia.

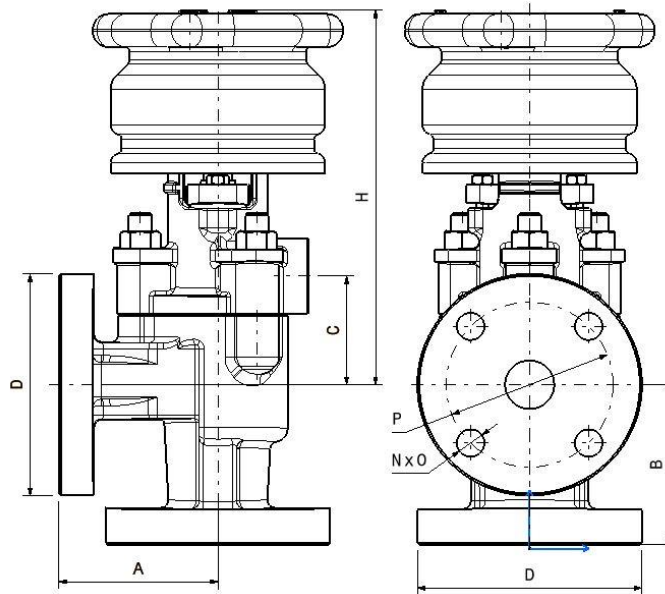

## Material

Item	Part Name	Material
1	Water Leg	Cast iron   Gunmetal
2	Water Leg valve seat	Stainless steel
3	Stuffing box	Cast iron   Gunmetal
4	Spindle	Stainless steel
5	Hand wheel	Aluminum
6	Retaining nut	Stainless steel
7	Gland packing	Teflon packing
8	Gland follower	Stainless steel
9	ACME THRD nut	Brass
10	Valve Lid	Nickel alloy
11	Blow down seat	Nickel alloy
12	Split pin	Steel

